

495.3mm

40mm



<table border="0"> <tr> <td>COLOURS</td> <td></td> <td></td> <td></td> <td></td> </tr> <tr> <td></td> <td>1 C</td> <td>2 M</td> <td>3 Y</td> <td>4 K</td> </tr> <tr> <td></td> <td></td> <td></td> <td></td> <td></td> </tr> <tr> <td></td> <td>5 P367</td> <td>6 P478</td> <td>7 P REFLEX BLUE</td> <td>8 L631 VARNISH</td> </tr> </table>			COLOURS						1 C	2 M	3 Y	4 K							5 P367	6 P478	7 P REFLEX BLUE	8 L631 VARNISH
COLOURS																						
	1 C	2 M	3 Y	4 K																		
	5 P367	6 P478	7 P REFLEX BLUE	8 L631 VARNISH																		
CUSTOMER FYFFES INTERNATIONAL SA	BARCODE 5397005919440																					
DESCRIPTION FYFFES ORGANIC & FT BAND DOM REP NEW B/C	DATE 03.07.25	SURFACE/REVERSE PRINTED SURFACE																				
JOB REF: 9100035596	VERSION 03	OPERATOR PM																				

LABEL SIZE	
WIDTH 40.00	DEPTH 495.30
LEADING EDGE	
NARROW <input checked="" type="checkbox"/>	WIDE <input type="checkbox"/>
WOUND	
INSIDE <input type="checkbox"/>	OUTSIDE <input checked="" type="checkbox"/>

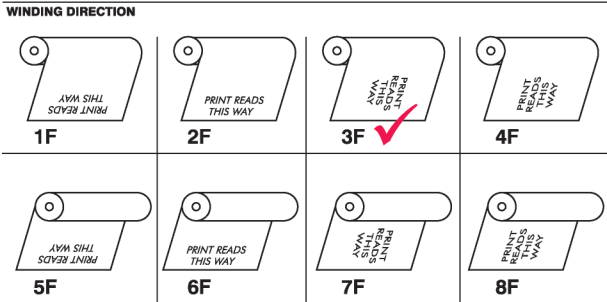

APPLICATION	
MACHINE <input checked="" type="checkbox"/>	HAND <input type="checkbox"/>
LABELS PER REEL / MAX OD 600	
CORE SIZE 76mm	
CUTTER REF 6917	

IF YOU HAVE RECEIVED A GMG PROOF FROM SAICA FLEX, IT CAN BE CONSIDERED AS AN ACCURATE PRESS MATCH FOR PROCESS ELEMENTS ONLY. PLEASE REFER TO A PANTONE BOOK FOR PANTONE COLOURS. PDF PROOFS ARE NOT ACCURATE AS A COLOUR MATCH. YOUR SIGNATURE IS OUR PERMISSION TO PRINT - NO LIABILITY FOR ERRORS CAN BE ACCEPTED THEREAFTER.

ARTWORK APPROVED <input type="checkbox"/>	ARTWORK NOT APPROVED AMEND AND RE-PROOF <input type="checkbox"/>
LABEL SPEC APPROVED <input type="checkbox"/>	LABEL SPEC NOT APPROVED AMEND AS INDICATED <input type="checkbox"/>

SIGNED _____ **DATE** _____

PLEASE NOTE: IN ORDER FOR THIS PDF TO VIEW CORRECTLY IN ADOBE READER, 'OVERPRINT PREVIEW' MUST BE SELECTED IN THE PAGE DISPLAY PREFERENCES. TO PRINT THE PDF, 'PRINT AS IMAGE' SHOULD BE SELECTED IN THE ADVANCED PRINT DIALOGUE

REV05-190822